



**भारतीय राष्ट्रीय राजमार्ग प्राधिकरण**  
(सड़क परिवहन एवं राजमार्ग मंत्रालय, भारत सरकार)  
(परियोजना कार्यावन्थन ईकाई-रेवारी)  
प्लॉट नं. 20, सैक्टर 32,  
गुड़गांव - 122003, (हरियाणा)

**National Highways Authority of India**  
(Ministry of Road Transport and Highways, Govt. of India)  
(Project Implementation Unit-Rewari)  
Plot No. 20, Sector 32, (Institutional Area),  
Gurgaon-122003, (Haryana)



ई-मेल / E-mail: piurewari@nhai.org, वेब / web: www.nhai.gov.in, फोन/Ph.: +91 124 3525610

PIU/ED/NH11/08/10/68/2024-25/2606

27.02.2025

### **Invitation of Public Comments**

**Sub: Proposal for the approval of overhead crossing of NH-11 (Jaisalmer to Rewari, between chainage -1.126 KM-1,193 KM) & NH-148B (Kothputli to Bathinda between Chainage 51.044 KM- 51.111 KM) by TL01 of 765 kV DC Sikar (II)-Narela Transmission Line associated with Transmission system for evacuation of Power from REZ Ph-III (Part D) through tariff based competitive bidding (TBCB) route.**

Deputy General Manager, Powergrid Sikar Khetri Transmission Limited, Narnaul (Mahendergarh) submitted the proposal for overhead crossing at Ch. 1+160 of NH-11 (Jaisalmer to Rewari, between chainage -1.126 KM-1,193 KM) & NH-148B (Kothputli to Bathinda between Chainage 51.044 KM- 51.111 KM) by TL01 of 765 kV DC Sikar (II)-Narela Transmission Line associated with Transmission system for evacuation of Power from REZ Ph-III (Part D) through tariff based competitive bidding (TBCB) route in the State of Haryana.

2. From the submitted proposal, it is seen that the Crossing of Electric Line, length is proposed for 60m. As per the guidelines, issued by the Ministry vide OM No.RW/NH-33044/29/ 2015/ S&R(R) dated 22.11.2016, the application shall be put out in the public domain for 30 days for seeking claims and objections (on grounds of public inconvenience, safety and general public interest).

3. In view of the above, comments of the public on the above application are invited to the below mentioned address, which should reach by this office within 30 days from the date of publication beyond which no comments shall be entertained.

**The Project Director,**  
**National Highways Authority of India**  
Project Implementation Unit- Rewari  
Plot no. 20, Sector 32, Gurugram  
Haryana, 122003

**Encl:** As above.

  
**(Yogesh Tilak)**  
Project Director

### **Copy to:**

1. Technical Director, NIC, Transport Bhawan, New Delhi- with request for uploading on the Ministry's website. (Email: mansoor@nic.in).
2. Regional Officer - Delhi, NHAI- for kind information.
3. Deputy General Manager, Powergrid Sikar Khetri Transmission Limited, Narnaul (Mahendergarh) - for information.



## CHECK- LIST

Guidelines for processing the proposal for laying of Utility line in the land along National Highways vested with NHAI/PWD/BRO.

### General Information

1. Name and Address of the Applicant/Agency : POWERGRID SIKAR KHETRI  
TRANSMISSION LIMITED, Vinayak vistar, word no 21, Neem ka Thana Sikar,  
Rajasthan-332713.
2. National Highway No.: NH-11
3. State: Hariyana
4. Location: Gehli
5. Chainage in km: BETWEEN 1.126 KM & 1.193 KM
6. Length in m: 61 M
7. Width of available ROW in both side: 67 M
8. Side of NH : ACROSS THE NH-11  
(left or right side of NH towards increasing chainage/Km direction)
9. Name of Highway Authority of NHAI/PWD/BRO: PIU-REWARI
10. Highway Administration address: PIU-REWARI

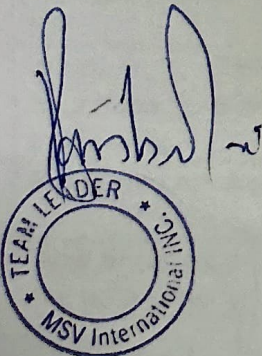

दया शंकर चौबे  
दया शंकर चौबे / Daya Shankar Chaubey  
उप महाप्रबंधक / Deputy General Manager  
पावरग्रिड कॉर्पोरेशन ऑफ इण्डिया लिमिटेड  
Powergrid Corporation of India Limited



S.No	Item	Measurement. Observations as per site conditions	MORTH Norms	Whether complying with MORTH Norms
1	Details of already laid utility service, if any	NA		
2	Whether up gradation of the stretch in near future is proposed or not	NO		
	(a) If yes, provision of utility adversely affect the plan of up-gradation	NA	Not affect plan of up-gradation	
3	<b>Laying of the utility service along the National Highways.</b>	Overhead crossing of NH-11		
3.1.	Location of proposed utility service along the stretch	Near Village Gehli, Tehsil Narnaul, Rajasthan KM 1.126 & KM 1.193 (Drawing Enclosed)	Utility Duct/ beyond the toe line of the embankment and drains, and close to the extreme edge of the RoW.	
3.2	Depth of top of utility service from ground level		0.6 meter	NA
3.3	Mechanism for crossing water channel	NA	Through utility duct (if provision exists) or beneath the bed of water channel	NA
3.4	Whether ROW is restricted in this stretch?	No (Towers are beyond the restricted ROW)		
3.4.1	If yes, whether provision of land acquisition is required to lay utility	NA		
	(a) If yes, whether undertaking for land acquisition along with relevant L.A. details has been furnished	NA		
3.4.2	Width of concrete duct, if utility services are proposed to be laid in concrete ducts	NA	NA	
4	<b>Laying of utility services across the NH</b>			
4.1	Whether Existing drainage structures is allowed to carry the utility lines.	NO (overhead crossing)	Not to be allowed	
4.2	Proposed crossing of utility service	Close to perpendicular	Perpendicular to NH	
4.3	Type of casing, pipe/conduit carrying the utility line.	Overhead AL-59 Conductor	Steel, cast iron, or reinforcement	



Deputy General Manager  
 उप महाप्रबंधक / Deputy General Manager  
 पावरग्रिड कॉर्पोरेशन ऑफ इंडिया लिमिटेड  
 Powergrid Corporation of India Limited

			concrete and have adequate strength	
4.4	Whether ends of the casing/conduit pipe are sealed from the outside	Overhead AL-59 Conductor	Sealed	
4.5	Length of casing/conduit pipe crossing NH.	Overhead AL-59 Conductor	Extend from drain to drain in cuts and toe to toe of slope in the fills	
4.6	Depth of top of the casing/conduit pipe.	Overhead AL-59 Conductor	At least 1.2 m below the top of subgrade	
4.7	Crossing method in case of CC pavement.	NA	Only boring method (HDD)	
4.8	Horizontal and vertical clearances in case utilities are allowed overhead,	Mentioned in drawing	In accordance with IRC codes.	
5	<b>Document / Drawings enclosed with the proposal</b>			
5.1	Cross-Section showing the size of trench for open trenching method	NA	Enclosed, if applicable	
	(a) Trench width	NA	More than 30 cm and less than 60 Cm wider than the outer diameter of the utility pipe	
	(b) Filling of trench	NA	as per Ministry guidelines vide letter No. RW/NH-34044/29/2015/S&R (R) dated 22.11.2016	
	(c) location of trench	NA	extreme edge of the ROW	
5.2	Cross section showing the size of pit and location of conduit for HDD method	NA	Enclosed, if applicable	
5.3	Strip plan/ Route plan showing utility line, chainage, width of ROW, distance of proposed utility from the edge of ROW, important mile stone, intersections, cross drainage works etc.	Enclosed	Enclosed	
5.4	Plan and profile drawing of stretch showing cross section of road at 20m distance along with ROW and proposed utility	Enclosed	Enclosed	
6	Methodology for laying of utility line	Enclosed	Enclosed	



दया शंकर चौबे  
 दया शंकर चौबे / Daya Shankar Chaubey  
 उप महाप्रबंधक / Deputy General Manager  
 पावरग्रिड कॉर्पोरेशन ऑफ इण्डिया लिमिटेड  
 Powergrid Corporation of India Limited



7	Draft License Agreement is as per Ministry guidelines vide letter No. RW/NH-34044/29/2015/S&R (R) dated 22.11.2016 and signed by two witnesses	Enclosed	Enclosed	
8	License fees in Favor of MoRTH RPAO Jaipur	Shall be submitted on Demand, if applicable	As per Ministry vide circular no. RE/NH-33044/29/2015/S&(R)dated 22.11.2016	
9	Whether Bank Guarantee has been obtained	Shall be submitted on Demand	As per Ministry vide circular no. RE/NH-33044/29/2015/S&(R)dated 22.11.2016	
	(a) If yes, whether Confirmation of BG has been obtained as per MoRTH/NHAI guidelines	Shall be submitted on Demand after confirmation		
10	<b>Affidavit / Undertaking from the Applicant for</b>			
10.1	Undertaking for not to damage other existing utility, if damaged then to pay the losses to either to MoRTH/NHAI or to the concerned agency.	Enclosed	Enclosed	
10.2	Undertaking for renewal of Bank Guarantees and when asked by NHAI/ MoRTH	Enclosed	Enclosed	
10.3	Undertaking for confirming all standard condition of MoRTH/NHAI guidelines.	Enclosed	Enclosed	
10.4	Undertaking for shifting of utility as and when asked by MoRTH/ NHAI within a month at their own cost.	Enclosed	Enclosed	
10.5	Undertaking for indemnity against all damages and claims.	Enclosed	Enclosed	
10.6	Undertaking for management of traffic movement during laying of utility line without hampering the traffic.	Enclosed	Enclosed	
10.7	Undertaking that If any claim is raised by the Concessionaire/contractor then the same has to be paid by the applicant	Enclosed	Enclosed	
10.8	Undertaking that the applicant has obtained various safety clearances from the representative authorities such as directorate of Electricity,	Enclosed	Enclosed	



दया शंकर चौबे  
 दया शंकर चौबे / Daya Shankar Chaubey  
 उप महाप्रबंधक / Deputy General Manager  
 पावरग्रिड कॉर्पोरेशन ऑफ इण्डिया लिमिटेड  
 Powergrid Corporation of India Limited

Chief controller of Explosives, Petroleum and Explosive Safety Organization, Oil Industry Safety Directorate, State/Central Pollution Control Board and any other statutory clearance s applicable, before applying to Highway Administration			
--	--	--	--

The Right of the Way (ROW) of the National Highway available at the proposed location from the center line of divided carriage way is (..... )m (from center of ROW to edge of ROW towards proposed utility)



The above particulars along with the drawings and documents have been verified and certified as correct as per prevailing site conditions.

दयाशंकर चौबे

[Name Designation and signature of  
the authorized representative of  
applicant]

[Name Designation and signature of  
concerned field authority of  
NHAI/PWD/BRO]

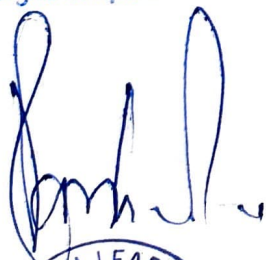
दया शंकर चौबे / Daya Shankar Chaubey  
उप महाप्रबंधक / Deputy General Manager  
पावरग्रिड कॉर्पोरेशन ऑफ इण्डिया लिमिटेड  
Powergrid Corporation of India Limited



B16  
DA15  
W.S.C. 211(L) 221(R) = 423  
W.S.H. 200(L) 215(R) = 417  
X 30353.25  
Y 310657.74  
Elevation: 338.93

AP82  
DA450  
W.S.C. 180(L) 120(R) = 308  
W.S.H. 180(L) 120(R) = 313  
X 30303.78  
Y 310652.9  
Elevation: 338.5

AP83  
DA140  
W.S.C. 120(L) 150(R) = 277  
W.S.H. 120(L) 140(R) = 272  
X 30336.79  
Y 310712.18  
Elevation: 338.11

DA150  
W.S.C. 120(L) 120(R) = 312  
W.S.H. 120(L) 120(R) = 315  
X 30353.25  
Y 310762.00  
Elevation: 334.06

DA150  
W.S.C. 160(L) 195(R) = 359  
W.S.H. 160(L) 195(R) = 360  
X 30383.62  
Y 310747.60  
Elevation: 333.58

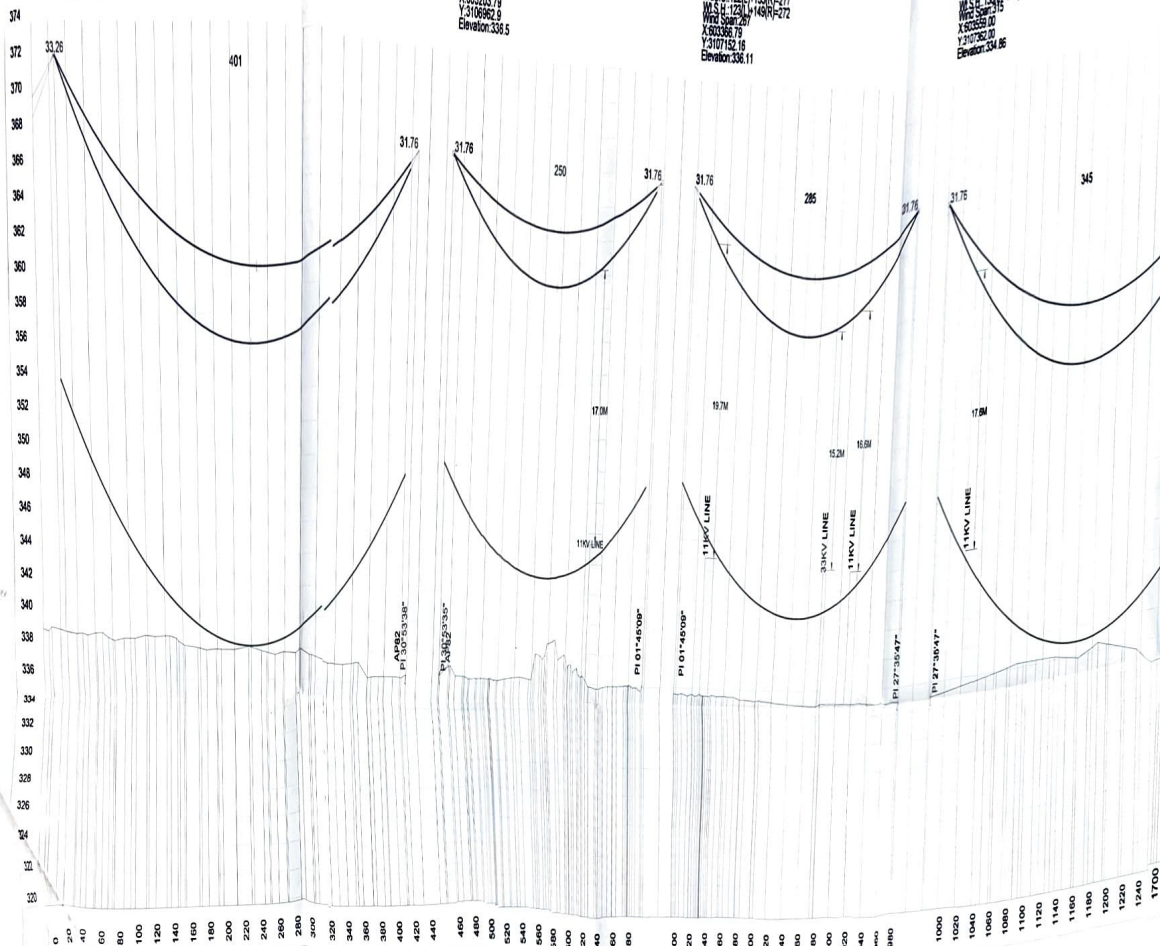

CANAL	
BRICKS ROAD/HOUSE	
33 KV LINE/POLE	
11KV LINE/POLE	
CONCRETE ROAD	
LT LINE	
TRANSMISSION LINE	
POND	
COLD CURVE	
HOT CURVE	
GROUND CLERANCE	
STATE HIGHWAY	
POULTRY FARM	
METAL ROAD	

#### CONDUCTOR PARAMETERS

1. NAME	: AL58 ZEBRA
2. DIAMETER (mm)	: 27.72
3. UNIT WEIGHT(Kg/m)	: 1.254
4. AREA (Sq.mm)	: 454.0

#### CONDITION

1. NORMAL SPAN (m)	: 400
2. GROUND CLEARANCE (m)	: 18.0
3. MAXIMUM SAG (m)	: 13.61
4. TENSION AT MAXIMUM (85°C)	: 1842.8 Kg
5. TENSION AT MINIMUM (0°C)	: 2878.2 Kg
6. SAG ERROR (m)	: 0.150

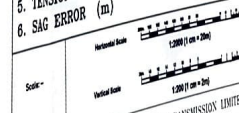

CLIENT	POWERGRID SIKAR-AHETH TRANSMISSION LIMITED
CONTRACTOR	Skipper Limited

Project: 765KV D/C SIKAR (U)-NARELA (Part I) Transmission Line (TL01)

Line Name: 765KV D/C SIKAR(U)-NARELA Transmission Line(TL01)

Section: AP81/6-AP84

Client: Skipper Limited

Submitted By: [Signature]

Checked By: [Signature]

Submitted By: [Signature]

Checked By: [Signature]

B16

30°53'30" RT  
AP  
AP82

1°43'00" RT  
AP  
AP83

27°25'47" RT  
ES1

48°00'58" LT  
CT  
AP84





**भारतीय राष्ट्रीय राजमार्ग प्राधिकरण**  
(सड़क परिवहन एवं राजमार्ग मंत्रालय, भारत सरकार)  
(परियोजना कार्यावन्तर्गत ईकाई-रेवाड़ी)  
प्लॉट नं. 20, सेक्टर 32,  
गुडगांव - 122003, (हरियाणा)

**National Highways Authority of India**  
(Ministry of Road Transport and Highways, Govt. of India)  
(Project Implementation Unit-Rewari)  
Plot No. 20, Sector 32, (Institutional Area),  
Gurgaon-122003, (Haryana)



ई-मेल / E-mail: piurewari@nhai.org, वेब / web: www.nhai.gov.in, फोन/Ph.: +91 124 3525610

पीआईयू/ईसी/1111/08/10/68/2014-25/2606

दिनांक: 24/02/2014

### सार्वजनिक टिप्पणियों का आमंत्रण

**विषय:** टैरिफ आधारित प्रतिस्पर्धी बोली (टीबीसीबी) मार्ग के माध्यम से आरईजेड पीएच-III (भाग डी) से बिजली की निकासी के लिए ट्रांसमिशन सिस्टम से जुड़ी 765 केवी डीसी सीकर (II)-नरेला ट्रांसमिशन लाइन के टीएल01 द्वारा एनएच-11 (जैसलमेर से रेवाड़ी, चैनज-1.126 किमी-1,193 किमी के बीच) क्यू और एनएच-148बी (कोठपुतली से बठिंडा 51.044 किमी-51.111 किमी के बीच) के ओवरहेड क्रॉसिंग की मंजूरी के लिए प्रस्ताव।

आवेदक उप महाप्रबंधक, पावरग्रिड सीकर खेत्री ट्रांसमिशन लिमिटेड, नारनौल (महेंद्रगढ़) ने हरियाणा राज्य में टैरिफ आधारित प्रतिस्पर्धी बोली (टीबीसीबी) मार्ग के माध्यम से आरईजेड पीएच-III (भाग डी) से बिजली की निकासी के लिए ट्रांसमिशन सिस्टम से जुड़ी 765 केवी डीसी सीकर (II)- नरेला ट्रांसमिशन लाइन के टीएल01 द्वारा एनएच-11 (जैसलमेर से रेवाड़ी, चैनज-1.126 किमी-1,193 किमी के बीच) और एनएच-148बी (कोठपुतली से बठिंडा 51.044 किमी-51.111 किमी के बीच) का ट्रांसमिशन लाइनों की ओवरहेड क्रॉसिंग का प्रस्ताव प्रस्तुत किया है।

2. प्रस्तुत प्रस्ताव से, यह देखा गया है कि विद्युत लाइन की क्रॉसिंग, लंबाई 60 मीटर के लिए प्रस्तावित है। मंत्रालय के दिनांक 22.11.2016 के कार्यालय ज्ञापन संख्या आरडब्लू/एनएच 33044/29/2015/एसएंडआर@ के अनुसार, राजमार्ग प्रशासक जनहित के आधार पर 30 दिनों के लिए सार्वजनिक टिप्पणियों के लिए उपयोगिता बिछाने की अनुमति मांगने वाला प्रस्ताव उपलब्ध कराएंगे।

3. उपरोक्त के मददेनजर, उपर्युक्त प्रस्ताव पर जनता की टिप्पणियां आमंत्रित की जाती हैं और ये टिप्पणियां 30 दिनों के भीतर उपर्युक्त पते पर पहुंच जानी चाहिए, इसके बाद किसी भी टिप्पणी पर विचार नहीं किया जाएगा। यह क्षेत्रीय अधिकारी सह राजमार्ग प्रशासक के अनुमोदन से जारी किया जा रहा है।

संलग्न: उपरोक्त अनुसार।

योगेश तिलक  
(योगेश तिलक)

डीजीएम(टी)/परियोजना निदेशक

### प्रतिलिपि ::

1. तकनीकी निदेशक, एनआईसी, परिवहन भवन, नई दिल्ली- मंत्रालय की वेबसाइट पर अपलोड करने के अनुरोध सहित।
2. आरओ (दिल्ली), एनएचएआई-मुख्यालय, द्वारका, नई दिल्ली।
3. उप महाप्रबंधक, पावरग्रिड सीकर खेत्री ट्रांसमिशन लिमिटेड, नारनौल (महेंद्रगढ़)-जानकारी के लिए।



# PROPOSAL FOR 765kV D/C (HEXA) SIKAR(II) - NARELA TRANSMISSION LINE OVERHEAD CROSSING OF N.H.-11 BETWEEN CHAINAGE 1.126 K.M. & 1.193 K.M. NEAR- GEHLI VILLAGE, MAHENDRAGARH DISTRICT

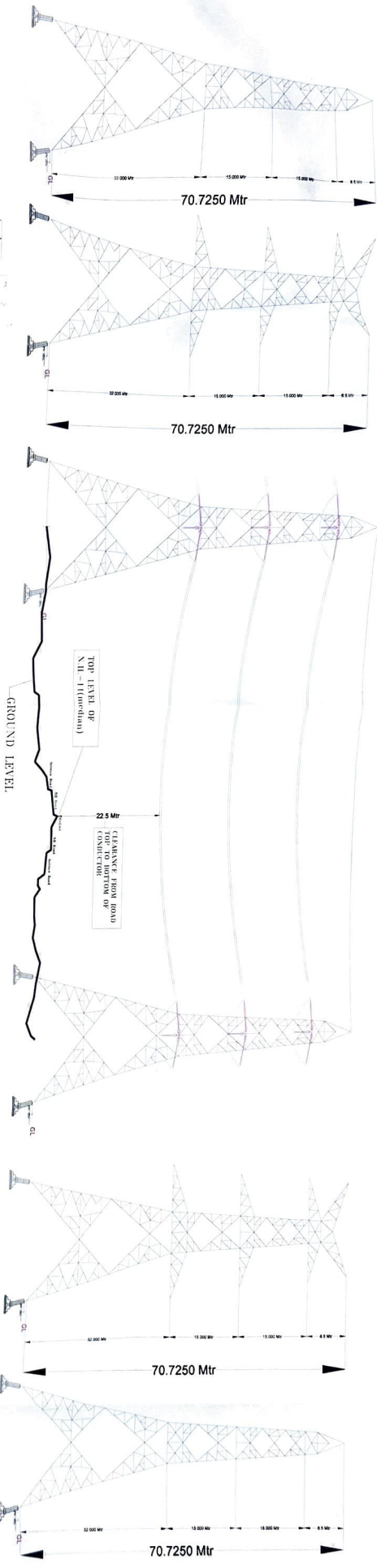

TOP UP STUB DIAGONAL & BACK TO BACK OF TOWER TYPE : DBK540

TOP UP STUB DIAGONAL & BACK TO BACK OF TOWER TYPE : DBT1-0

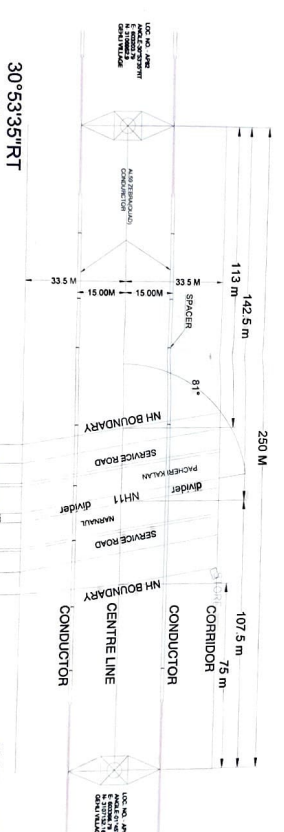
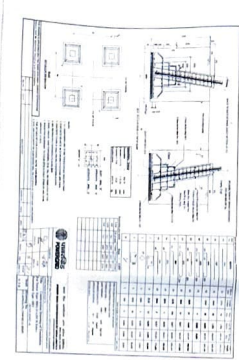

SITE PLAN  
TOTAL CROSSING SPAN OF TWO TOWERS 250 M

30°53'35"RT  
AP82

1°45'09"RT  
AP83

EARTHWIRE DETAILS:

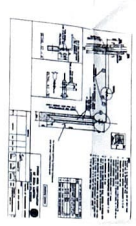

As per IRC 67

Overhead Cables Sign



DETAILS OF INSULATOR & JAWBOLT FITTING  
FACTOR OF SAFETY = 2.1

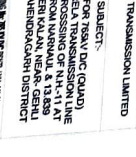
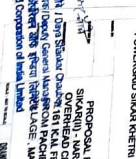
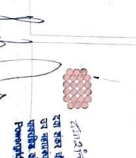
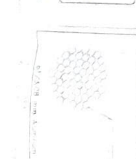
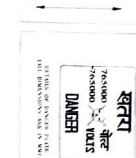
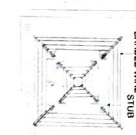
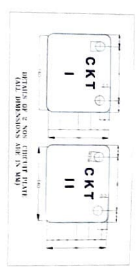
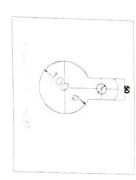
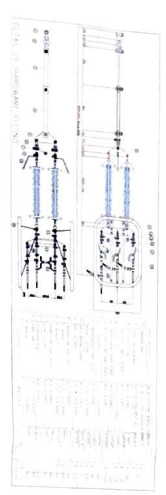

MAHENDRAGARH DISTRICT

PROPOSAL FOR 765kV D/C (HEXA) SIKAR(II) - NARELA TRANSMISSION LINE OVERHEAD CROSSING OF N.H.-11 BETWEEN CHAINAGE 1.126 K.M. & 1.193 K.M. NEAR- GEHLI VILLAGE, MAHENDRAGARH DISTRICT